

Photo

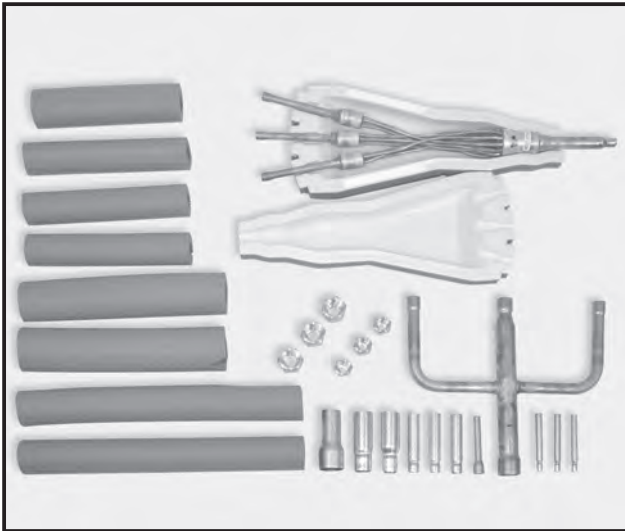

Descriptions

3-branch pipe for Multi-System Triple use. (33:33:33)

Applicable Models

- PUAZ-ZRP100,125,140VKA3 ■ PU-P140YHAR6
 - PUAZ-ZRP100,125,140YKA3
 - PUAZ-ZRP200,250YKA3
 - PUAZ-P140VKA
 - PUAZ-P140YKA
 - PUAZ-P200,250YKA3
- [R410A type]
for 33:33:33 Triple use

Specifications

Main body	Distribution ratio	Outdoor unit capacity is divided into three (33:33:33)
	Number of distribution pipes	1 each for liquid pipe and gas pipe
	Pipe material	Phosphate deoxidized copper C1220T-OL (JIS H3300)
Accessory	Pipe cover	Polyethylene foam molding (for liquid pipe) EPT sponge rubber type (for gas pipe)
	Joint	13 joints (7 types)

Dimensions

Unit: mm

LIQUID PIPE

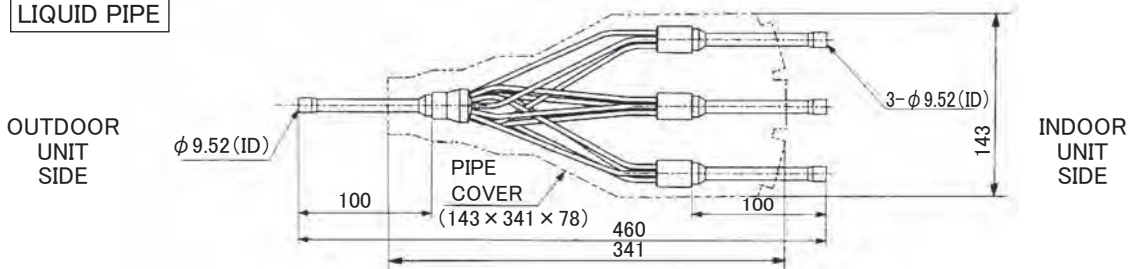

GAS PIPE

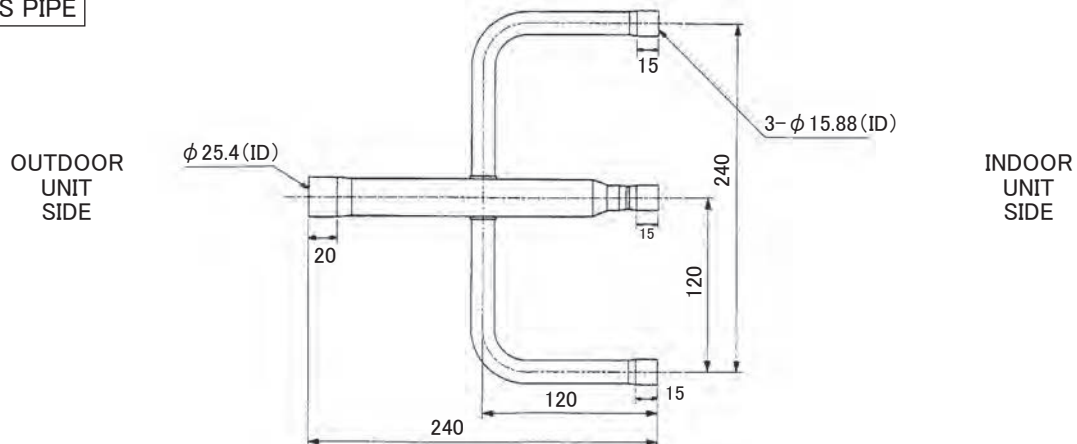

JOINT(Accessary)

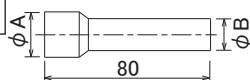

ØA(ID)	ØB(OD)	Amount
12.7	9.52	1
28.6	25.4	1

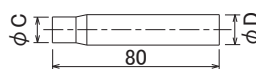

ØC(ID)	ØD(OD)	Amount
12.7	15.88	3
19.05	25.4	1
6.35	9.52	3
15.88	25.4	1
9.52	15.88	3

OPTIONAL PARTS

How to Use / How to Install

Package Air-conditioner Optional Parts Instruction Sheet for Simultaneous Triple Distributing Pipe exclusively used with Free Compo Multi-Units

Make sure that you have all the following parts in packing box before beginning installation:

① Instruction sheet This sheet 1 sheet	② Gas pipe 1pc	③ Liquid pipe 1pc	④ Pipe cover (for gas pipe) 1pc	⑤⑥ Pipe covers (for gas pipe) ⑤ Outerø50×250-1pc ⑥ Outerø43×350-2pc	⑦ Pipe cover (for liquid pipe) 2pcs	⑧⑨ Pipe covers ⑧ Outerø42×180-1pc ⑨ Outerø38×200-3pcs	⑩ Bands 8pcs	⑪ Joint See Table 1.	⑫ Flare nut ⑬ 1/4F.....3pcs ⑭ 1/2F.....3pcs For R410A indoor unit.
---	-----------------------	--------------------------	--	---	--	---	---------------------	-----------------------------	---

• See the following for the specifications of gas pipe ② and liquid pipe ③ :

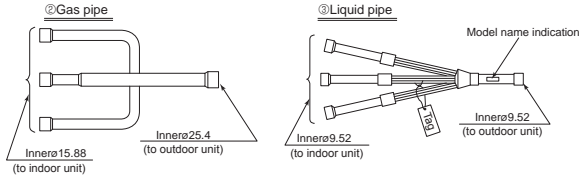

Note:
The following items must be obtained locally in addition to the packed parts.
⑮ Heat insulating sealing tape
⑯ Extension pipe for refrigerant pipe

Joint specifications and provided numbers <Table 1>

Sizes of joint pipe ends (mm)	Numbers provided
Ⓐ Outerø9.52-Innereø6.35	3
Ⓑ Outerø9.52-Innereø12.7	1
Ⓒ Outerø15.88-Innereø12.7	3
Ⓓ Outerø25.4-Innereø19.05	1
Ⓔ Outerø25.4-Innereø15.88	1
Ⓕ Outerø25.4-Innereø28.6	1
Ⓖ Outerø15.88-Innereø9.52	3

Pipe size and limit to refrigerant pipe

■ For R410A inverter

Outdoor unit capacity	Pipe size (mm)				Actual pipe length (m)			Difference of elevation (m)		Note 1 Number of bends
	Gas pipe side		Liquid pipe side		Indoor-Outdoor	A+B+C+D=	Indoor-Outdoor	Indoor-Outdoor		
	Outdoor unit side	Indoor unit side	Outdoor unit side	Indoor unit side						
ZRP100	ø15.88 <5/8>	ø9.52 <3/8>	ø9.52 <3/8>	ø6.35 <1/4>	-	75m or less	B-C = 8m or less	H = 30m or less	h = 1m or less	15 or less
(ZR)P125, 140		ø12.7 <1/2>	ø9.52 <3/8>	ø6.35 <1/4>	-	75m or less				
(ZR)P200	ø25.4 <1>	ø15.88 <5/8>	ø9.52 <3/8>	ø9.52 <3/8>	A + B = A + C = A + D =	100m or less	B-C = 8m or less	H = 30m or less	h = 1m or less	15 or less
(ZR)P250		ø12.7 <1/2>	ø9.52 <3/8>	ø9.52 <3/8>	100m or less					

Note 1: Limit the number of bends for refrigerant pipes to 8 in each of the <A+B>, <A+C> and <A+D> ranges.
• See the installation manual provided with the main unit for details on charge-less pipe length and refrigerant additional charge amount.

<Fig. 1>

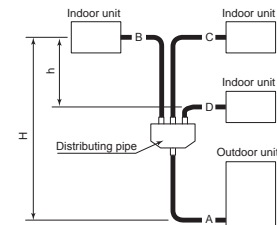

Pipe connections

1. Perform work, taking care with the following:

- Be sure to check the combination pattern of indoor and outdoor units, joints to be used <Table 3>, pipe size <Table 1> and joint ⑪.
- Be sure to observe the limits to refrigerant pipe length and number of bends <Table 2>.
- Insert the refrigerant pipe (procured at local site) and joint ⑪ into the expanded pipe portions of distributing pipe (this product) until they stop, and then connect them using anti-oxidization soldering.
- There is no restriction on the orientation of distributing pipe (this product) during installation.
- Take care that no foreign object, such as dust, enters during pipe connecting work.
- Remove the tag of liquid pipe ③ after checking it.

2. Pipe connections

- The provided joints ⑪ will be necessary depending on the capability of model used: See <Table 3>, and connect the refrigerant piping.
- Do not bend or widen the distributing pipe (liquid pipe).

Combination pattern of indoor and outdoor units and joints to be used:

■ For R410A inverter		Joint to be used	
Outdoor unit	Indoor unit	⑧ Outerø25.4-innereø15.88[outdoor gas pipe side]×1, ⑨ Outerø15.88-innereø9.52[indoor gas pipe side]×3, ⑩ Outerø9.52-innereø6.35[indoor liquid pipe side]×3	
ZRP100	35+35+35	⑧ Outerø25.4-innereø15.88[outdoor gas pipe side]×1, ⑨ Outerø15.88-innereø9.52[indoor gas pipe side]×3, ⑩ Outerø9.52-innereø6.35[indoor liquid pipe side]×3	
(ZR)P125, 140	50+50+50	⑧ Outerø25.4-innereø15.88[outdoor gas pipe side]×1, ⑨ Outerø15.88-innereø9.52[indoor gas pipe side]×3, ⑩ Outerø9.52-innereø6.35[indoor liquid pipe side]×3	
(ZR)P200	60+60+60	No Joint is necessary	
(ZR)P250	71+71+71	⑧ Outerø9.52-innereø12.7[outdoor liquid pipe side]×1	

Note 1: Installation positions in brackets [].