

Photo

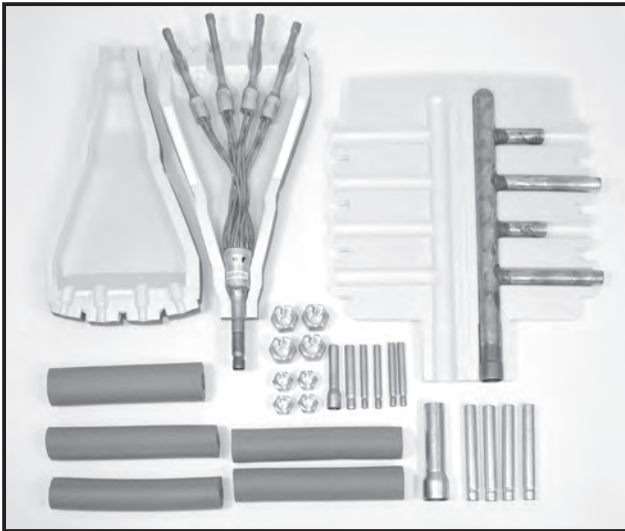

Descriptions

4-branch pipe for Multi-System Quadruple use. (25:25:25:25)

Applicable Models

- PUAZ-ZRP125,140VKA3
 - PUAZ-ZRP125,140YKA3
 - PUAZ-ZRP200,250YKA3
 - PUAZ-P200,250YKA3
- for 25:25:25:25 Quadruple use
[R410A type]

Specifications

Main body	Distribution ratio	Outdoor unit capacity is divided into four (25:25:25:25)
	Number of distribution pipes	1 each for liquid pipe and gas pipe
	Pipe material	Phosphate deoxidized copper C1220T-OL (JIS H3300)
Accessory	Pipe cover	Polyethylene foam molding (for liquid pipe) EPT sponge rubber type (for gas pipe)
	Joint	15 joints (7 types)
	Band	7 bands

Dimensions

Unit: mm

LIQUID PIPE

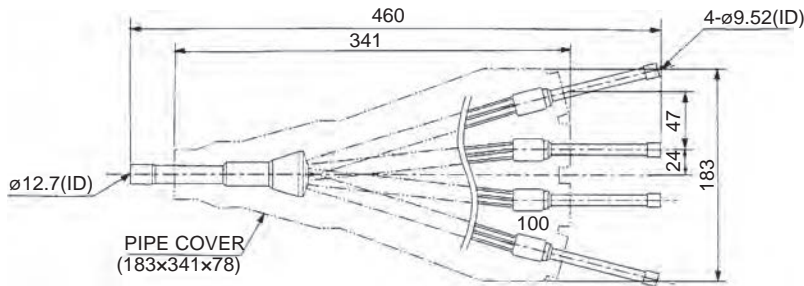

GAS PIPE

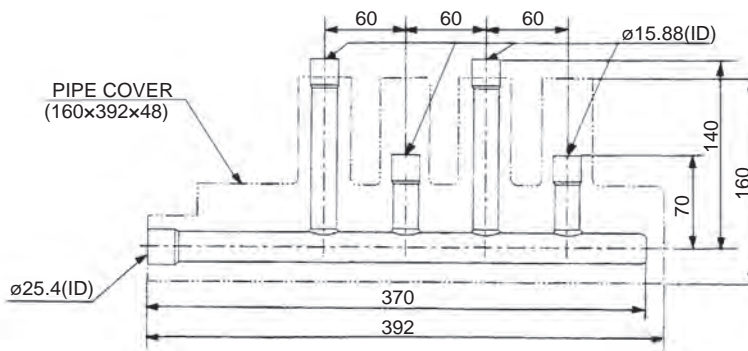

JOINT(Accessory)

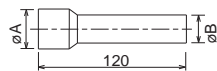

ØA(ID)	ØB(OD)	Amount
28.6	25.4	1
15.88	12.7	1

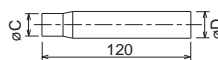

ØC(ID)	ØD(OD)	Amount
12.7	15.88	4
6.35	9.52	4
9.52	12.7	1
15.88	25.4	1
9.52	15.88	4

OPTIONAL PARTS

How to Use / How to Install

Package Air-conditioner Optional Parts Instruction Sheet for Simultaneous Quadruple Distributing Pipe exclusively used with Free Compo Multi-Units

Make sure that you have all the following parts in packing box before beginning installation:

① Installation manual This sheet 1 sheet	② Gas pipe 1pc	③ Liquid pipe 1pc	④ Pipe cover (gas pipe) 1pc	⑤ Pipe covers (liquid pipe) 2pcs	⑥ Pipe cover ⑥ OD.Ø42×180L—1pc ⑦ Ø38×200L—4pcs	⑧ Band 7pcs	⑨ Joint Ø9.52→Ø6.35..... 4pcs Ø12.7→Ø9.52..... 1pcs Ø12.7→Ø15.88..... 1pcs Ø15.88→Ø12.7..... 4pcs Ø25.4→Ø28.6..... 1pc Ø25.4→Ø15.88..... 1pc Ø15.88→Ø9.52..... 4pcs	⑩ Flare nut 1/4F.....4pcs 1/2F.....4pcs For R410A indoor unit.
---	-------------------	----------------------	--------------------------------	-------------------------------------	--	----------------	--	---

● the gas pipe ② and liquid pipe ③ are specified as shown below.

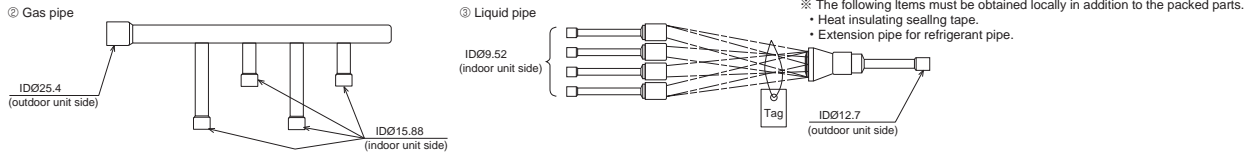

Pipe size and refrigerant pipe limits.

Outdoor unit capacity	Pipe size (mm)				Actual pipe length (m)			Difference of elevation (m)		Number of bends Note 1
	Gas pipe side		Liquid pipe side		Indoor-Outdoor	A+B+C+D=	Indoor-Indoor	Indoor-Outdoor	Indoor-Indoor	
(ZR)P200	ø25.4 <1>	ø12.7 <1/2>	ø9.52 <3/8>	ø6.35 <1/4>	A + B = A + C = A + D = A + E = 100m or less	100m or less	B-C = B-E = C-D = C-E = D-E = 8m or less	H = 30m or less	h = 1m or less	15 or less
(ZR)P250	ø25.4 <1>	ø15.88 <5/8>	ø12.7 <1/2>	ø9.52 <3/8>	100m or less	100m or less	B-C = B-E = C-D = C-E = D-E = 8m or less	H = 30m or less	h = 1m or less	15 or less
ZRP125,140 ZM125,140	ø15.88 <5/8>	ø9.52 <3/8>	ø9.52 <3/8>	ø6.35 <1/4>	-	75m or less	B-C = B-E = C-D = C-E = D-E = 8m or less	H = 30m or less	h = 1m or less	15 or less

Note 1: The number of bends in the refrigerant pipes is respectively 8 or less in the range of (A+B) (A+C) (A+D) (A+E) .

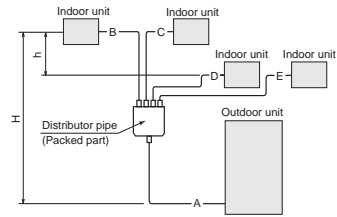

Pipe connections

- Perform work, taking care with the following:
 - Be sure to check the combination pattern of indoor and outdoor units, joints to be used (Table 2), pipe size and joint used ⑩.
 - Be sure to observe the limits to refrigerant pipe length and number of bends (Table 1).
 - Insert the refrigerant pipe (procured at local site) and joint ⑨ into the expanded pipe portions of distributing pipe (this product) until they stop, and then connect them using anti-oxidization soldering.
 - There is no restriction on the orientation of distributing pipe (this product) during installation.
 - Take care that no foreign object, such as dust, enters during pipe connecting work.
 - Remove the tag of liquid pipe ③ after checking it.
- Pipe connections
 - The provided joints ⑨ will be necessary depending on the capability of model used: See (Table 2), and connect the refrigerant piping.
 - Do not bend or widen the distributing pipe (liquid pipe).

Combination pattern of indoor and outdoor units and joints to be used:

Outdoor unit	Indoor unit	Joint to be used
(ZR)P200	50+50+50+50	⑩ Outerø15.88-innerø12.7[indoor gas pipe side]×4, ⑩ Outerø9.52-innerø6.35[indoor liquid pipe side]×4, ⑩ Outerø12.7-innerø9.52[outdoor gas pipe side]×1
(ZR)P250	60+60+60+60	No Joint is necessary
ZRP125,140	35+35+35+35	⑩ Outerø25.4-innerø15.88[outdoor gas pipe side]×1, ⑩ Outerø15.88-innerø9.52[indoor gas pipe side]×4, ⑩ Outerø12.7-innerø9.52[outdoor liquid pipe side]×1, ⑩ Outerø9.52-innerø6.35[indoor liquid pipe side]×4